

Dunlap Stainless, Inc.

2905 Ramsey Road
Gainesville, GA 30507
(770) 531-1933 (Mon-Fri 8am-5pm)

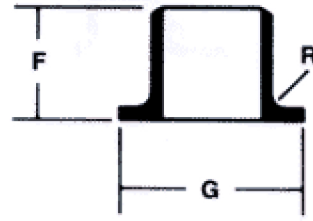

CAP



SHORT PATTERN STUB END

NOM PIPE SIZE	OUT- SIDE DIA. O.D.	F	G	CORNER RADIUS		O.D. OF BARREL*		E
				TYPE A	TYPE B	MAX.	MIN.	
				R	R			
1/2	0.84	2.00	1.38	0.12	0.03	0.896	0.809	1.00
3/4	1.05	2.00	1.69	0.12	0.03	1.106	1.019	1.00
1	1.32	2.00	2.00	0.12	0.03	1.376	1.284	1.50
1 1/4	1.66	2.00	2.50	0.19	0.03	1.716	1.629	1.50
1 1/2	1.90	2.00	2.88	0.25	0.03	1.965	1.869	1.50
2	2.38	2.50	3.62	0.31	0.03	2.456	2.344	1.50
2 1/2	2.88	2.50	4.12	0.31	0.03	2.966	2.844	1.50
3	3.50	2.50	5.00	0.38	0.03	3.596	3.469	2.00
3 1/2	4.00	3.00	5.50	0.38	0.03	4.096	3.969	2.50
4	4.50	3.00	6.19	0.44	0.03	4.593	4.469	2.50
5	5.56	3.00	7.31	0.44	0.06	5.683	5.532	3.00
6	6.62	3.50	8.50	0.50	0.06	6.743	6.594	3.50
8	8.62	4.00	10.62	0.50	0.06	8.743	8.594	4.00
10	10.75	5.00	12.75	0.50	0.06	10.913	10.719	5.00
12	12.75	6.00	15.00	0.50	0.06	12.913	12.719	6.00
14	14.00	6.00	16.25	0.50	0.06	14.170	13.969	6.50
16	16.00	6.00	18.50	0.50	0.06	16.180	15.969	7.00
18	18.00	6.00	21.00	0.50	0.06	18.190	17.969	8.00
20	20.00	6.00	23.00	0.50	0.06	20.240	19.969	9.00
22	22.00	6.00	25.25	0.50	0.06	22.240	21.969	10.00
24	24.00	6.00	27.25	0.50	0.06	24.240	23.969	10.50

*O.D. OF BARREL APPLIES TO STUB ENDS ONLY
ALL DIMENSIONS ARE IN INCHES
ALL DIMENSIONS ARE IN ACCORDANCE WITH ASME/ANSI B16.9
THE LAP THICKNESS SHALL NOT BE LESS THAN THE NOMINAL THICKNESS SPECIFIED