

# Dunlap Stainless, Inc.

2905 Ramsey Road  
Gainesville, GA 30507

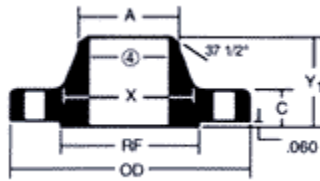

## Class 300 Flanges



WELD NECK

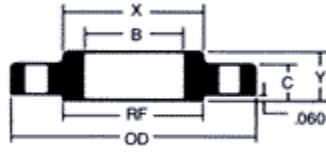

SLIP-ON

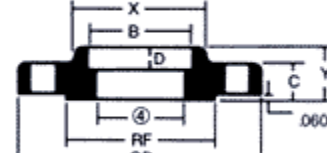

SOCKET WELD

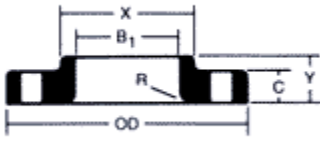

LAP JOINT

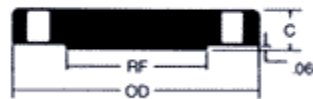

BLIND

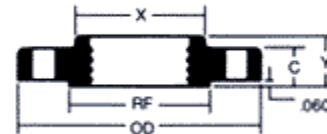

THREADED

| NOM PIPE SIZE | CLASS 300* |      |       |       |        |                |       |                |      |         |       |                  |                   |
|---------------|------------|------|-------|-------|--------|----------------|-------|----------------|------|---------|-------|------------------|-------------------|
|               | OD         | C    | X     | A     | Y      | Y <sub>1</sub> | B     | B <sub>1</sub> | R    | D       | RF    | BOLT CIRCLE DIA. | BOLT HOLE QTY/DIA |
| 1/2           | 3.75       | 0.56 | 1.50  | 0.84  | 0.88   | 2.06           | 0.88  | 0.90           | 0.12 | 0.38    | 1.38  | 2.62             | 4/0.62            |
| 3/4           | 4.62       | 0.62 | 1.88  | 1.05  | 1.00   | 2.25           | 1.09  | 1.11           | 0.12 | 0.44    | 1.69  | 3.25             | 4/0.75            |
| 1             | 4.88       | 0.69 | 2.12  | 1.32  | 1.06   | 2.44           | 1.36  | 1.38           | 0.12 | 0.50    | 2.00  | 3.50             | 4/0.75            |
| 1 1/4         | 5.25       | 0.75 | 2.50  | 1.66  | 1.06   | 2.56           | 1.70  | 1.72           | 0.19 | 0.56    | 2.50  | 3.88             | 4/0.75            |
| 1 1/2         | 6.12       | 0.81 | 2.75  | 1.90  | 1.19   | 2.69           | 1.95  | 1.97           | 0.25 | 0.62    | 2.88  | 4.50             | 4/0.88            |
| 2             | 6.50       | 0.88 | 3.31  | 2.38  | 1.31   | 2.75           | 2.44  | 2.46           | 0.31 | 0.69    | 3.62  | 5.00             | 8/0.75            |
| 2 1/2         | 7.50       | 1.00 | 3.94  | 2.88  | 1.50   | 3.00           | 2.94  | 2.97           | 0.31 | 0.75    | 4.12  | 5.88             | 8/0.88            |
| 3             | 8.25       | 1.12 | 4.62  | 3.50  | 1.69   | 3.12           | 3.57  | 3.60           | 0.38 | 0.81    | 5.00  | 6.62             | 8/0.88            |
| 4             | 10.00      | 1.25 | 5.75  | 4.50  | 1.88   | 3.38           | 4.57  | 4.60           | 0.44 | 0.94*** | 6.19  | 7.88             | 8/0.88            |
| 5             | 11.00      | 1.38 | 7.00  | 5.56  | 2.00   | 3.88           | 5.66  | 5.69           | 0.44 | 0.94*** | 7.31  | 9.25             | 8/0.88            |
| 6             | 12.50      | 1.44 | 8.12  | 6.63  | 2.06   | 3.88           | 6.72  | 6.75           | 0.50 | 1.06*** | 8.50  | 10.62            | 12/0.88           |
| 8             | 15.00      | 1.62 | 10.25 | 8.63  | 2.44   | 4.38           | 8.72  | 8.75           | 0.50 | 1.25*** | 10.62 | 13.00            | 12/1.00           |
| 10            | 17.50      | 1.88 | 12.62 | 10.75 | 2.62** | 4.62           | 10.88 | 10.92          | 0.50 | 1.31*** | 12.75 | 15.25            | 16/1.12           |
| 12            | 20.50      | 2.00 | 14.75 | 12.75 | 2.88** | 5.12           | 12.88 | 12.92          | 0.50 | 1.56*** | 15.00 | 17.75            | 16/1.25           |
| 14            | 23.00      | 2.12 | 16.75 | 14.00 | 3.00** | 5.62           | 14.14 | 14.18          | 0.50 | 1.63*** | 16.25 | 20.25            | 20/1.25           |
| 16            | 25.50      | 2.25 | 19.00 | 16.00 | 3.25** | 5.75           | 16.16 | 16.19          | 0.50 | 1.75*** | 18.50 | 22.50            | 20/1.38           |
| 18            | 28.00      | 2.38 | 21.00 | 18.00 | 3.50** | 6.25           | 18.18 | 18.20          | 0.50 | 1.94*** | 21.00 | 24.75            | 24/1.38           |
| 20            | 30.50      | 2.50 | 23.12 | 20.00 | 3.75** | 6.38           | 20.20 | 20.25          | 0.50 | 2.12*** | 23.00 | 27.00            | 24/1.38           |
| 24            | 36.00      | 2.75 | 27.62 | 24.00 | 4.19** | 6.62           | 24.25 | 24.25          | 0.50 | 2.50*** | 27.25 | 32.00            | 24/1.62           |

ALL DIMENSIONS ARE IN INCHES

\* IN ACCORDANCE WITH ASME/ANSI B16.5

\*\* NOT APPLICABLE TO LAP JOINTS

\*\*\* INDUSTRY PRACTICE